

Fire Separations

Fire separations, also known as fire doors, are located within your workplace because the components of this type of door helps reduce the spread of smoke and fire.

Fire separations, also known as fire doors, are located within your workplace because the components of this type of door helps reduce the spread of smoke and fire.

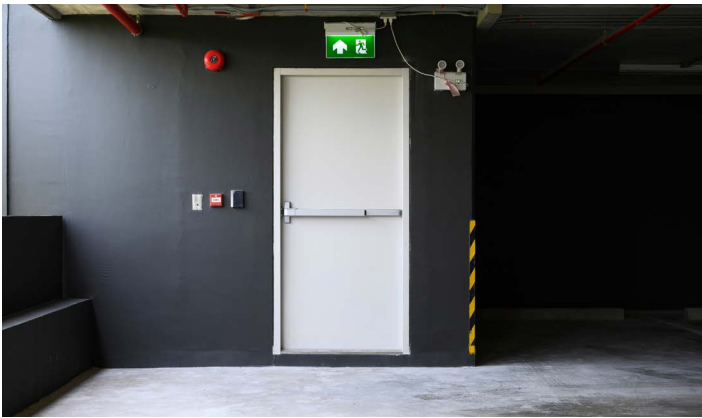

How do you know when you should have fire doors in your workplace?

The following excerpt is from the [National Fire Safety Code 2.2.1.1.](#)

- Where a building contains more than one major occupancy, such occupancies shall be separated from each other in conformance with the NBC (National Building Code).
- Where rooms or spaces within a building contain a high-hazard industrial occupancy, such occupancy shall be separated from the remainder of the building by fire separations in conformance with this Code and the NBC.
- Rooms, corridors, shafts and other spaces shall be separated where practicable by fire separations conforming to the NBC.

These doors must always be closed when not in use; they cannot be propped open. These doors are required to be equipped with self-closing devices.

Everyone may understand the requirements, but if people do not know how to identify a fire door there may be a chance that someone will prop open this type of door without realizing the consequences the action may have.

A fire door can easily be identified as it has a label installed along the hinged part of the door containing the fire rating and a designated serial number and plate. This door is rated as a 3/4 hour rating. You can locate the serial number directly below the red outline in the image below:



The fire rated label must always be legible. It cannot be painted over or removed. If any part of the label is covered, painted over, or the label is removed, the door is no longer compliant and needs to be replaced (National Fire Code of Canada 2015 (2.2.2.4.))

It's a best practice to check the labels on all your fire doors while completing inspections. It's also good practice to let contractors, especially painters know the regulations regarding these doors (specifically labels) so they can be careful to not paint over any portion of them.

Do you need more information? RPM can help!

RPM's [Workplace Inspection Training](#) course is now online! This workshop is designed to give people a better understanding of what they are looking at during workplace inspections. Upon completion, participants will:

- be able to explain the requirements and the purpose(s) of a workplace inspection,
- know what they're looking for and how to identify a hazard,
- be able to explain the process of what to do when there are inspection findings, and
- understand the process for implementing corrective actions and how to monitor and identify trends.

Please note RPM courses are offered to RPM registered companies only. Your company must be registered with RPM and be in the process of working towards certification or must have achieved the SAFE Work Manitoba Trucking Certificate of Recognition. Not yet registered in the RPM program? Today is a great day to get started!



» RISK. PROFESSIONALLY MANAGED.

Phone: 204-632-6600 | Email: info@rpmsafety.ca | Web: www.rpmsafety.ca

Address: 25 Bunting Street Winnipeg, MB R2X 2P5